

\$28,260 - 232 Lansdowne Street, Granum

MLS® #A1234139

\$28,260

0 Bedroom, 0.00 Bathroom,
Land on 0.14 Acres

NONE, Granum, Alberta

Welcome to Lansdowne Street! Opportunity at an affordable price! The Hamlet of Granum is the perfect place to settle down if you are done with the noise and busy atmosphere of city living! This lot is located on a pretty street and has back alley access! Granum is approximately 45 minute drive from Lethbridge and an hour and a half from Calgary! If this lot interests you, call your Realtor today!

Essential Information

MLS® #	A1234139
Price	\$28,260
Bathrooms	0.00
Acres	0.14
Type	Land
Sub-Type	Residential Land
Status	Active

Community Information

Address	232 Lansdowne Street
Subdivision	NONE
City	Granum
County	Willow Creek No. 26, M.D. of
Province	Alberta
Postal Code	T0L 1A0

Exterior

Lot Description	Back Lane, Rectangular Lot
-----------------	----------------------------

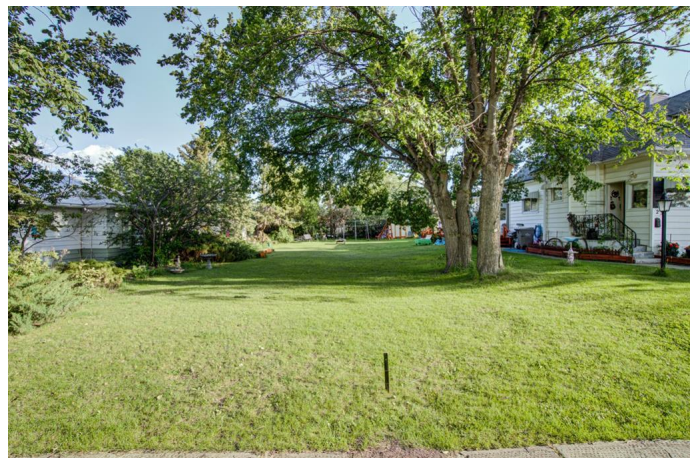

Additional Information

Date Listed	July 4th, 2022
Days on Market	1019
Zoning	R1

Listing Details

Listing Office	CENTURY 21 FOOTHILLS REAL ESTATE
----------------	----------------------------------

Data is supplied by Pillar 9â„¢ MLS® System. Pillar 9â„¢ is the owner of the copyright in its MLS® System. Data is deemed reliable but is not guaranteed accurate by Pillar 9â„¢. The trademarks MLS®, Multiple Listing Service® and the associated logos are owned by The Canadian Real Estate Association (CREA) and identify the quality of services provided by real estate professionals who are members of CREA. Used under license.