

# \$699,000 - 159 Lake Sylvan Close Se, Calgary

MLS® #A2202190

**\$699,000**

0 Bedroom, 0.00 Bathroom,  
Land on 0.15 Acres

Bonavista Downs, Calgary, Alberta

Click brochure link for more details. Presenting a fantastic opportunity for developers and investors! This prime piece of land is ready for your next project – a perfect site to build a spacious duplex (Building Permit is pending). Located in a highly sought-after area, the property offers exceptional potential for capital growth.

Key features: The lot is ready to demo, we have the development permit-DP2024-07552, Asbest Test, Survey Plan, Off-site Levy has been paid, Demo Permit is issued, the duplex w/ the legal suits plans are ready.

Sizeable Lot: Generous land area ideal for constructing a modern duplex with ample space for both units and additional outdoor amenities.

Zoning: Zoned for RCG, making it a perfect candidate for a stylish duplex build w/ the legal basement suits, the plans are ready. Don't miss out on this rare opportunity to secure a well-located site for your next development. Photos are representative.

## Essential Information

MLS® #	A2202190
Price	\$699,000
Bathrooms	0.00



Email: [addressing@calgary.ca](mailto:addressing@calgary.ca) | Telephone: (403) 268-8127

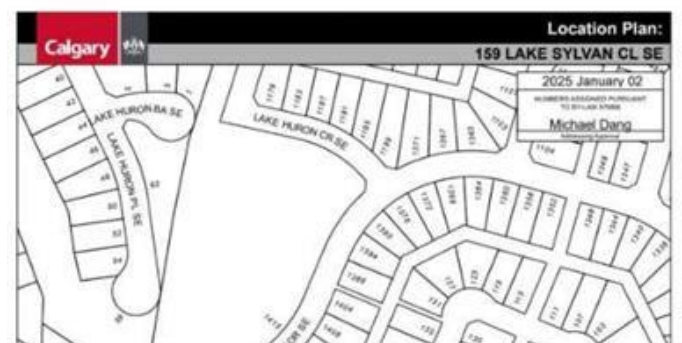

Acres	0.15
Type	Land
Sub-Type	Residential Land
Status	Active

### **Community Information**

Address	159 Lake Sylvan Close Se
Subdivision	Bonavista Downs
City	Calgary
County	Calgary
Province	Alberta
Postal Code	T2J 3E5

### **Additional Information**

Date Listed	March 14th, 2025
Days on Market	40
Zoning	R-CG

### **Listing Details**

Listing Office	Honestdoor Inc.
----------------	-----------------

Data is supplied by Pillar 9â„¢ MLSÂ® System. Pillar 9â„¢ is the owner of the copyright in its MLSÂ® System. Data is deemed reliable but is not guaranteed accurate by Pillar 9â„¢. The trademarks MLSÂ®, Multiple Listing ServiceÂ® and the associated logos are owned by The Canadian Real Estate Association (CREA) and identify the quality of services provided by real estate professionals who are members of CREA. Used under license.